



Features

- **Applications:** Shipping and receiving, warehouse, livestock, general purpose weighing
- **Loadcell:** Single point Alum. load cell, resolution up to 1/7500
- **Construction:** Durable checked steel platform for anti-slip
Heavy duty welded steel supports
With shipping screw protecting load cell against damage during transportation
Equipped with adjustable feet for quick set-up and stability
3m coil cable from base to indicator for durability and easy extension
- **Indicator:** Rugged ABS housing
Easy-to-read LCD display with backlit
4 keys: ZERO/ON/OFF, TARE, UNIT, PRINT/HOLD
- **Functions:** Weighing, Tare, Hold, Auto-off function

Specifications

Item	Parameters				
Model	PS-103-35	PS-103-68	PS-103-75	PS-103-180	PS-103-200
Capacity	35kgx0.01kg 77lbx0.02lb	68kgx0.02kg 150lbx0.05lb	75kgx0.05kg 165lbx0.1lb	180kgx0.1kg 397lbx0.2lb	200kgx0.1kg 440lbx0.2lb
Units of Measure	kg, lb				
Display	5 1/2 digits 0.65" (16.51mm) high, 7 segments, LCD display with backlit				
Serial Port	USB				
Power	9V 600mA adapter or 1x9V battery				
Operation Temp	-10°C to 40°C (14°F to 104°F)				
Platform size	305x305mm / 12"x12"				
Packing size	600x560x410mm/6pcs/ctn				
Shipping Weight	G.W.: 28kg N.W.: 25kg				
Approvals	CE and WEEE directive, UL/CE/BS/VI Energy approved power adapter				
Options	USB cable				

Dimensions (mm/inch)

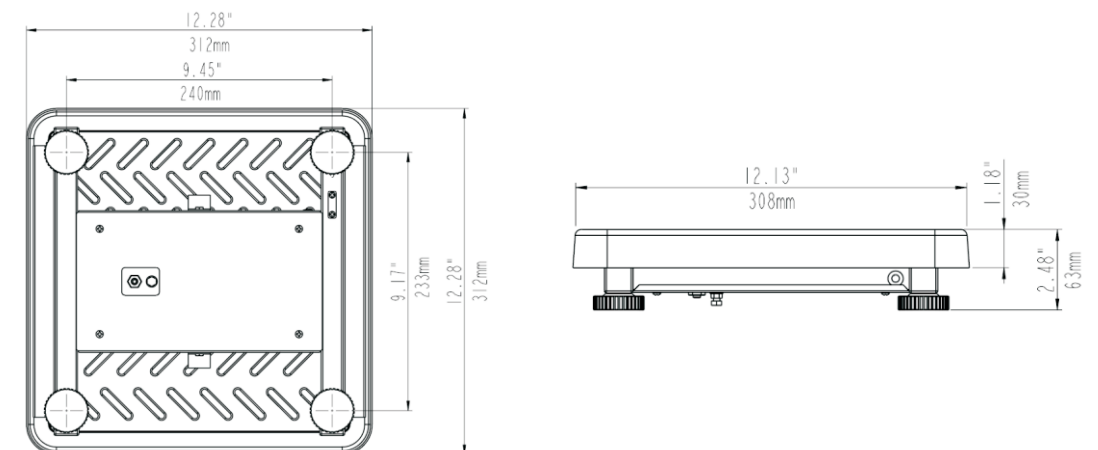

- **FSTN backlit LCD**, clear to see from any angle of view
- 4 keys for easy operation, with HOLD function



- Heavy duty structure with checked steel platform, equipped with high precision Alum. load cell
- Adjustable feet for quick set up and stability



- USB port, allows to communicate with computer